

Accessori Accessories



WIMOD

Trasmissione **WIRELESS**
WIRELESS transmission

OPZIONE  II 2G Ex ib IIC T6 Gb
OPTION II 2D Ex ib IIIC T70°C Db
Certificate: TÜV CY 18 ATEX 0206102 X

 Interamente saldata
al LASER
Completely LASER
welded



Linearità - Isteresi
≤ ± 0.03%
Linearity - Hysteresis

FACILE APPLICAZIONE

EASY APPLICATION

 SOLLECITAZIONI DINAMICHE
DYNAMIC STRESSES

Dimensioni Dimensions

[mm]

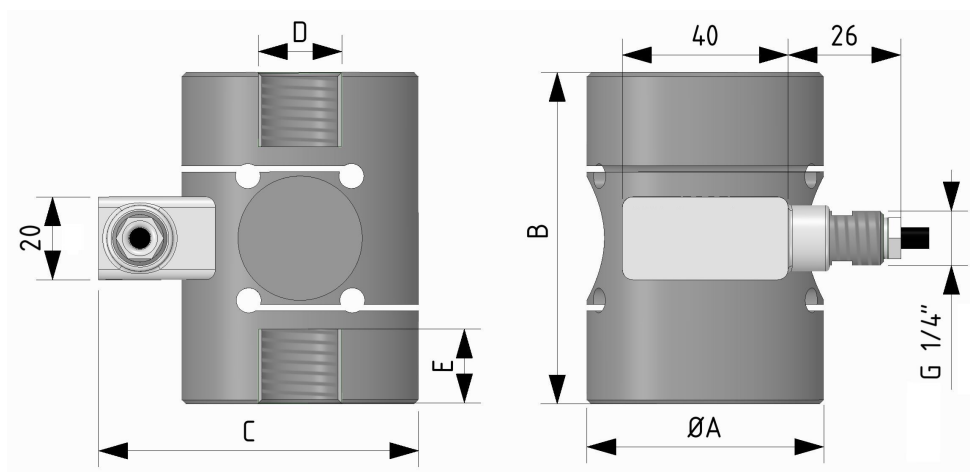

CODE	LOAD	ØA	B	C	D	E
CTCE57350K5	350 kg	57	80	74.5	M20X1.5	17
CTCE57500K5	500 kg					
CTCE571TK5	1 t					
CTCE572T55	2.5 t					
CTCE575T5 ⁽¹⁾	5 t					
CTCE825T5	5 t	82	110	102	M30X2	20
CTCE827T55	7.5 t					
CTCE8210T5	10 t					
CTCE8220T5	20 t					
		82	150	102	M42X3	30

Dati Tecnici
Technical Data



CARICO NOMINALE	NOMINAL LOAD	350 - 500 kg 1 - 2.5 - 5 ⁽¹⁾ t 7.5 -10 -20 t
SENSIBILITA' NOMINALE TOLLERANZA DI CALIBRAZIONE	NOMINAL SENSITIVITY SENSITIVITY TOLERANCE	2 mV/V ≤ ± 0.1 %
EFFETTO TEMPERATURA (10 °C) a) sullo zero b) sulla sensibilità	TEMPERATURE EFFECT (10 °C) a) on zero b) on sensitivity	≤ ± 0.030 % ≤ ± 0.011 %
LINEARITA' ISTERESI RIPETIBILITA'	LINEARITY HYSTERESIS REPEATABILITY	≤ ± 0.03 % ≤ ± 0.03 % ≤ ± 0.01 %
RESISTENZA DI INGRESSO RESISTENZA DI USCITA RESISTENZA DI ISOLAMENTO BILANCIAMENTO DI ZERO ALIMENTAZIONE DI RIFERIMENTO ALIMENTAZIONE NOMINALE ALIMENTAZIONE MAX.	INPUT RESISTANCE OUTPUT RESISTANCE INSULATION RESISTANCE ZERO BALANCE RECOMMENDED SUPPLY VOLTAGE NOMINAL SUPPLY VOLTAGE MAXIMUM SUPPLY VOLTAGE	440 ± 20 Ω 350 ± 2Ω >5 GΩ ≤ ±1 % 10 V 1 - 15 V 18 V
VALORI MECCANICI LIMITE RIFERITI AL CARICO NOMINALE: a) carico di servizio b) carico limite c) carico di rottura d) massimo carico trasversale e) carico dinamico limite FRECCIA MAX. AL CARICO NOMINALE	MECHANICAL LIMIT VALUES REFERRED TO NOMINAL LOAD: a) service load b) max permissible load c) breaking load d) max transverse load e) max permissible dynamic load DISPLACEMENT AT NOMINAL LOAD	120 % 150 % > 300 % 50 % 50 % ~ 0.3 mm
TEMPERATURA DI RIFERIMENTO CAMPO NOMINALE DI TEMPERATURA TEMPERATURA DI ESERCIZIO TEMPERATURA DI STOCCAGGIO	REFERENCE TEMPERATURE TEMPERATURE NOMINAL RANGE SERVICE TEMPERATURE STORAGE TEMPERATURE	+23 °C -10 / +40 °C -20 / +70 °C -20 / +80 °C
PESO da 350 kg a 5 t (Ø57) PESO da 5 t a 10 t (Ø82) PESO 20t (Ø82) CLASSE DI PROTEZIONE (EN 60529) MATERIALE DELLA CELLA LUNGHEZZA CAVO	WEIGHT from 350 kg to 5 t (Ø57) WEIGHT from 5 t to 10 t (Ø82) WEIGHT 20 t (Ø82) PROTECTION CLASS (EN 60529) EXECUTION MATERIAL CABLE LENGTH	~ 1.5 kg ~ 4.2 kg ~ 5 kg IP67 Acciaio Inox / Stainless Steel 5 m (on request 10 m)



⁽¹⁾ La cella di carico **5t Ø57** viene garantita in **TRAZIONE** fino a **2.5t**

The load cell **5t Ø57** is guaranteed in **TENSION** up to **2.5t**.

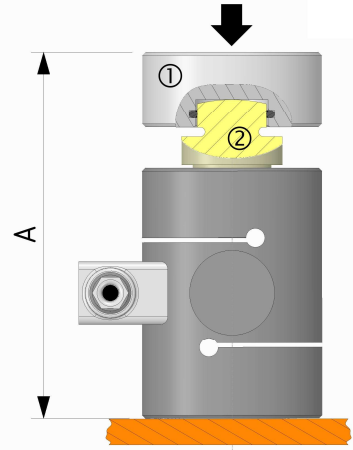
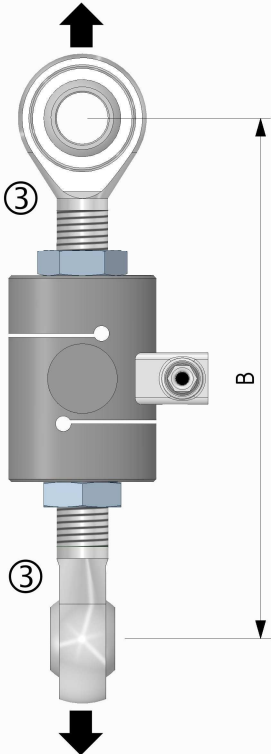
Applicazioni Applications

COMPRESSIONE <i>COMPRESSION</i>	TRAZIONE <i>TENSION</i>
 <p style="text-align: center;"> TCE 350kg, 500kg, 1t, 2.5t, 5t A = 117 mm TCE 5t, 7.5t, 10t A = 149 mm TCE 20t A = 198 mm </p>	 <p style="text-align: center;"> TCE 350kg, 500kg, 1t, 2.5t B = ~200mm TCE 5t, 7.5t, 10t B = ~300mm TCE 20t B = ~420mm </p>
<p>ATTENZIONE:</p> <p>Il peso del cavo può influire la misura, è pertanto consigliabile posizionarlo nella zona fissa dalla parte opposta al carico.</p>	<p>WARNING:</p> <p><i>Cable weight can influence measurement, it is therefore recommended to place it at the opposite site of the load.</i></p>

Accessori Accessories





TCE:	CODE:		ACCESSORIES (optional):	ACCESSORI (opzionali):
350kg, 500kg 1t, 2.5t, 5t	CTIC22	①	<i>Loading head.</i>	Testa di carico
	CTS25M20	②	<i>Spherical loading head.</i>	Testa di carico sferica.
	CACCEM20	③	<i>Knuckle joints.</i>	Teste a snodo sferico
5t, 7.5t, 10t	CTIC28	①	<i>Loading head.</i>	Testa di carico
	CTS45M30	②	<i>Spherical loading head.</i>	Testa di carico sferica.
	CACCEM30	③	<i>Knuckle joints.</i>	Teste a snodo sferico
20 t	CTIC35	①	<i>Loading head.</i>	Testa di carico
	CTS62M42	②	<i>Spherical loading head.</i>	Testa di carico sferica.
	CACCEM42	③	<i>Knuckle joints.</i>	Teste a snodo sferico



OPZIONI

Da acquistare separatamente

OPTIONS

To be purchased separately

	CODE	⁽²⁾ OPZIONE	⁽²⁾ OPTION
	CMIL6MF	Uscita diretta connettore MIL6M	<i>Direct output connector MIL6M</i>
	CMIL6FV5	CONNETTORE MIL6M femmina 6 poli dritto completo di CAVO PVC schermato lunghezza 5 m.	<i>Female 6 poles straight MIL6M CONNECTOR complete PVC CABLE, shielded, length 5 m.</i>

	CODE	⁽³⁾ OPZIONE	⁽³⁾ OPTION
	CONNM12MF	Uscita diretta connettore M12	<i>Direct output connector M12</i>
	CONNM12FV5	CONNETTORE M12x1 femmina 5 poli dritto completo di CAVO PVC costampato schermato lunghezza 3 m.	<i>Female 5 poles straight M12x1 CONNECTOR complete PVC molded CABLE, shielded, length 3 m.</i>

	CRT	Rapporto di taratura. Compressione o Trazione.	<i>Calibration Report. Compression or Tension</i>
---	------------	---	---

Collegamenti Elettrici

Electrical Connections

USCITA STANDARD: cavo schermato PVC 105°C, Ø 5.2 mm a 4x Ø 0.35mm² conduttori stagnati. Schermo collegato al corpo del trasduttore.

STANDARD OUTPUT: PVC 105°C shielded cable, Ø 5.2mm with 4x Ø 0.35mm² tinned conductors. Shield connected to the body of the transducer.

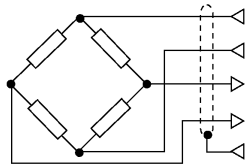
<i>Load cell</i>	OUTPUT	CABLE	CAVO	MIL6M ⁽²⁾ (optional)	M12 ⁽³⁾ (optional)
	EXCITATION +	Red	Rosso	A	1
	EXCITATION -	Black	Nero	B	3
	OUTPUT +	White	Bianco	D	2
	OUTPUT -	Yellow	Giallo	C	4
	-----	Shield	Schermo	F	5

AEP transducers



Dasa-Rägister
EN ISO 9001:2015
IQ 1100-01



LAT N° 093
Calibration Centre
The products are NOT covered by accreditation



Production Quality Assurance Certified n°
TÜV CY 17 ATEX 0205891 Q

41126 Cognento (MODENA) Italy Via Bottego 33/A Tel: +39-(0)59-346441 Fax: +39-(0)59-346437 E-mail: aep@aep.it

SYSTEM TECHNOLOGY
SWEDEN AB

www.systemtech.se

+46 (0)13 35 70 30 • sales@systemtech.se
Linnégatan 14 • 582 25 LINKÖPING

dotto, la società si riserva di apportare variazioni senza preavviso.
duct, the company reserves the right to make any change without notice.